

# MINERAL INSULATED THERMOCOUPLE



**NMA** : thermocouple type

*Description:*

Mineral insulated thermocouple sensor without connection head.

*Temperature:* „J” and „L” type 0...750 °C, „K” type 0...1100 °C ,  
 „T” type -190...400 °C, „E” type 0...900 °C, „N” type 0...1200 °C

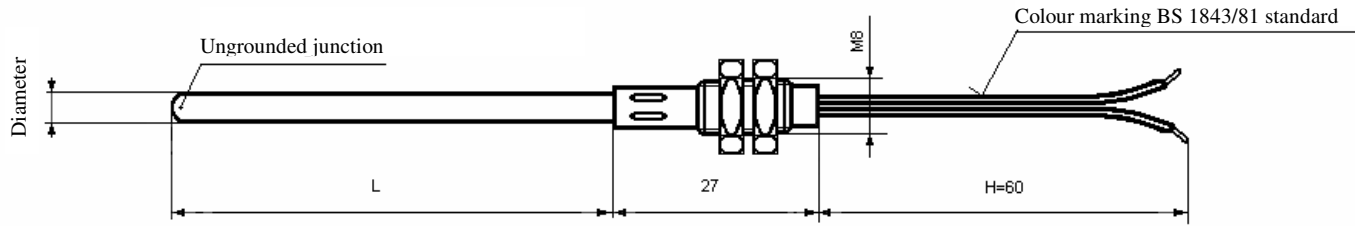

**Ordering code:**

N	M	A							
---	---	---	--	--	--	--	--	--	--

Type of mineral insulated thermocouple:

- „J” Fe-CuNi 0...750 °C (IEC584)
- „L” Fe-CuNi0...750 ° (DIN 43710)
- „K” NiCr-Ni 0...1100 °C (IEC584)
- „T” Cu-CuNi -190...400°C(IEC584)
- „E” NiCr-CuNi 0...900 °C (IEC584)
- „N” NiCrSi-NiSi0...1200 °C(IEC584)
- Other

J
L
K
T
E
N
9

Class of accuracy (IEC584):

- I.
- II.

1
2

Construction:

- Single
- Double

1
2

Material of min. insulated TC:

- 1.4541
- 1.4841
- Pyrosil
- Inconel
- Other

1
2
3
4
9

Diameter of mineral insulated thermocouple (mm):

- 0,5
- 1
- 1,5
- (2)
- 3
- (4,5)

--

Insertion length:

L (mm)

--

**Naturally, we can differ from the above construction.**

Please, fill in the ordering code and send your enquiry (order) to us.

fax: 00-36-1-282-6135 , e-mail: [ugyfelsz@rhodium.hu](mailto:ugyfelsz@rhodium.hu) , We will discuss the details.

If you have question, please call: 00-36-1-282-5689 and 00-36-1-282-8308, Our customer service is available.